

MR01

Particulars of a charge



Companies House



Go online to file this information
www.gov.uk/companieshouse

A fee is payable with
Please see 'How to pay' or

WEDNESDAY



S6CH5GPD

SCT

09/08/2017

#27

COMPANIES HOUSE

www.gov.uk/companieshouse

☒ **What this form is for**
You may use this form to register
a charge created or evidenced by
an instrument.

☐ **What this form is NOT for**
You may not use this form to
register a charge where there is no
instrument. Use form MR08.

This form **must be delivered to the Registrar for registration within 21 days** beginning with the day after the date of creation of the charge. If delivered outside of the 21 days it will be rejected unless it is accompanied by a court order extending the time for delivery.



You **must** enclose a certified copy of the instrument with this form. This will be scanned and placed on the public record. **Do not send the original.**

1 Company details

Company number S C 5 2 3 1 8 6

Company name in full CALEDONIA FIRE AND SECURITY PROPERTY COMPANY
LIMITED

For official use

→ Filling in this form

Please complete in typescript or in
bold black capitals.

All fields are mandatory unless
specified or indicated by *

2 Charge creation date

Charge creation date 2 5 0 7 2 0 1 7

3 Names of persons, security agents or trustees entitled to the charge

Please show the names of each of the persons, security agents or trustees
entitled to the charge.

Name THE FIFE COUNCIL

Name

Name

Name

If there are more than four names, please supply any four of these names then
tick the statement below.

☐ I confirm that there are more than four persons, security agents or
trustees entitled to the charge.

MR01

Particulars of a charge

4	Brief description	
	Please give a short description of any land, ship, aircraft or intellectual property registered or required to be registered in the UK subject to a charge (which is not a floating charge) or fixed security included in the instrument.	Please submit only a short description. If there are a number of plots of land, aircraft and/or ships, you should simply describe some of them in the text field and add a statement along the lines of, "for more details please refer to the instrument".
Brief description	0.405 HECTARES OF LAND AT WHEATFIELD ROAD KIRKCALDY AS SHOWN DELINEATED AND HATCHED RED ON THE PLAN ANNEXED TO STANDARD SECURITY BY CALEDONIA FIRE AND SECURITY PROPERTY COMPANY LIMITED DATED 14 AND 29 JUNE 2017.	Please limit the description to the available space.
5	Other charge or fixed security	
	Does the instrument include a charge (which is not a floating charge) or fixed security over any tangible or intangible or (in Scotland) corporeal or incorporeal property not described above? Please tick the appropriate box. <input type="checkbox"/> Yes <input checked="" type="checkbox"/> No	
6	Floating charge	
	Is the instrument expressed to contain a floating charge? Please tick the appropriate box. <input type="checkbox"/> Yes Continue <input checked="" type="checkbox"/> No Go to Section 7 Is the floating charge expressed to cover all the property and undertaking of the company? <input type="checkbox"/> Yes	
7	Negative Pledge	
	Do any of the terms of the charge prohibit or restrict the company from creating further security that will rank equally with or ahead of the charge? Please tick the appropriate box. <input type="checkbox"/> Yes <input checked="" type="checkbox"/> No	
8	Trustee statement ^①	
	You may tick the box if the company named in Section 1 is acting as trustee of the property or undertaking which is the subject of the charge. <input type="checkbox"/>	^① This statement may be filed after the registration of the charge (use form MR06).
9	Signature	
	Please sign the form here.	
Signature	Signature X <i>Shelia Rodger</i> X	
	This form must be signed by a person with an interest in the charge.	

MR01

Particulars of a charge



Presenter information

You do not have to give any contact information, but if you do, it will help Companies House if there is a query on the form. The contact information you give will be visible to searchers of the public record.

Contact name **SHEILA RODGER**

Company name **FIFE COUNCIL**

Address **FIFE HOUSE**

NORTH STREET

Post town **GLENROTHES**

County/Region **FIFE**

Postcode **K Y 7 5 L T**

Country **SCOTLAND**

DX **561502**

Telephone **03451555555 EXT.442211**



Certificate

We will send your certificate to the presenter's address if given above or to the company's Registered Office if you have left the presenter's information blank.



Checklist

We may return forms completed incorrectly or with information missing.

Please make sure you have remembered the following:

- ☐ The company name and number match the information held on the public Register.
- ☐ You have included a certified copy of the instrument with this form.
- ☐ You have entered the date on which the charge was created.
- ☐ You have shown the names of persons entitled to the charge.
- ☐ You have ticked any appropriate boxes in Sections 3, 5, 6, 7 & 8.
- ☐ You have given a description in Section 4, if appropriate.
- ☐ You have signed the form.
- ☐ You have enclosed the correct fee.
- ☐ Please do not send the original instrument; it must be a certified copy.



Important information

Please note that all information on this form will appear on the public record.



How to pay

A fee of £23 is payable to Companies House in respect of each mortgage or charge filed on paper.

Make cheques or postal orders payable to 'Companies House.'



Where to send

You may return this form to any Companies House address. However, for expediency, we advise you to return it to the appropriate address below:

For companies registered in England and Wales:
The Registrar of Companies, Companies House,
Crown Way, Cardiff, Wales, CF14 3UZ.
DX 33050 Cardiff.

For companies registered in Scotland:
The Registrar of Companies, Companies House,
Fourth floor, Edinburgh Quay 2,
139 Fountainbridge, Edinburgh, Scotland, EH3 9FF.
DX ED235 Edinburgh 1
or LP - 4 Edinburgh 2 (Legal Post).

For companies registered in Northern Ireland:
The Registrar of Companies, Companies House,
Second Floor, The Linenhall, 32-38 Linenhall Street,
Belfast, Northern Ireland, BT2 8BG.
DX 481 N.R. Belfast 1.



Further information

For further information, please see the guidance notes on the website at www.gov.uk/companieshouse or email enquiries@companieshouse.gov.uk

This form is available in an alternative format. Please visit the forms page on the website at www.gov.uk/companieshouse



FILE COPY

CERTIFICATE OF THE REGISTRATION OF A CHARGE

Company number: 523186

Charge code: SC52 3186 0001

The Registrar of Companies for Scotland hereby certifies that a charge dated 25th July 2017 and created by CALEDONIA FIRE AND SECURITY PROPERTY COMPANY LIMITED was delivered pursuant to Chapter A1 Part 25 of the Companies Act 2006 on 9th August 2017.

Given at Companies House, Edinburgh on 11th August 2017



Companies House



**THE OFFICIAL SEAL OF THE
REGISTRAR OF COMPANIES**

Glenrothes

I hereby certify that this is a true copy of Standard Security by Caledonia Fire and Security Property Company Limited in favour of The Fife Council dated 14 & 29 June 2017
Shelia Rodger, Solicitor, Glenrothes

WE, CALEDONIA FIRE AND SECURITY PROPERTY COMPANY LIMITED, ,
a Company incorporated under the Companies Acts (under number SC523186) and having its registered office at Bordeaux House, 31 Kinnoull Street, Perth, PH1 5EN DO HEREBY in security of all sums due and that may become due by us to THE FIFE COUNCIL, constituted under section 2 of the Local Government etc. (Scotland) Act 1994 and having their principal offices at Fife House, North Street, Glenrothes, Fife, KY7 5LT, and their successors and assignees whomsoever, in terms of the Security Agreement between us the said Caledonia Fire and Security Property Company Limited and the said The Fife Council, executed by us of even date with our execution of these presents, GRANT a Standard Security in favour of the said The Fife Council and their successors and assignees whomsoever over ALL and WHOLE that plot or area of land at Wheatfield Road, Kirkcaldy in the County of Fife extending to 0.405 hectares or thereby all as the said plot or area of land is shown delineated and outlined in red and hatched red on the plan annexed and executed as relative hereto and forms part and portion of ALL and WHOLE the subjects more particularly described in Notarial Instrument by the Royal Burgh of Kirkcaldy recorded in the Division of the General Register of Sasines for the County of Fife on 4 June 1947; together with all rights pertaining thereto; The Standard Conditions specified in Schedule 3 to the Conveyancing and Feudal Reform (Scotland) Act 1970 and any lawful variation thereof operative for the time being shall apply except insofar as hereinafter varied, videlicet:- there shall be deleted from Standard Condition 1(a) the words "to the reasonable satisfaction of the creditor"; there shall be deleted from Standard Condition 1(c) the word "such" and substituted therefor the word "a" and there shall be deleted therefrom the words "as the creditor may require by notice in writing"; there shall be deleted from Standard Condition 5(a) the words "or, at the option of the creditor to permit the creditor to insure the security subjects in the names of the creditor and debtor"; there shall be deleted from Standard Condition 12 the words "standard security" and "thereof" and there shall be inserted in place of the word "thereof" the words "of the Standard Security"; and Standard Conditions 1(b), 2, 4(c), 5 (b), 5(d), 5(e), 6, 7, 9(1)(c) and 9(2) shall not apply in respect of the security hereby granted; And we grant warrandice; And we Caledonia Fire and

Security Company Limited and, by their execution hereof, the said The Fife Council hereby agree that this Standard Security will remain in effect only until

28 June 2032 : IN WITNESS WHEREOF these presents

partly printed and partly typewritten on this and the preceding page together with the Plan annexed are subscribed as follows:

They are subscribed for us and on our behalf by

First Signature.....*R Hutchison*.....

Print Full Name.....*ROBERT HUTCHISON*.....
(Director)

Second Signature.....*Charles Aaron Aderson*.....

Print Full Name.....*CHARLES AARON ADERSON*.....
(Director or company secretary or witness – delete as applicable)

If a witness is signing complete

Address.....*31 KINNOULL STREET, PERTH*.....

Occupation.....*SOLICITOR*.....

At.....*PERTH*.....

On (date).....*14/6/17*.....

And they are sealed with the common seal of The Fife Council and subscribed for and on their behalf by their Proper Officer at Glenrothes

Signature.....*Jane E. Masters*.....

Full Name.....*JANE ELIZABETH MASTERS*.....

On.....*29 JUNE 2017*.....

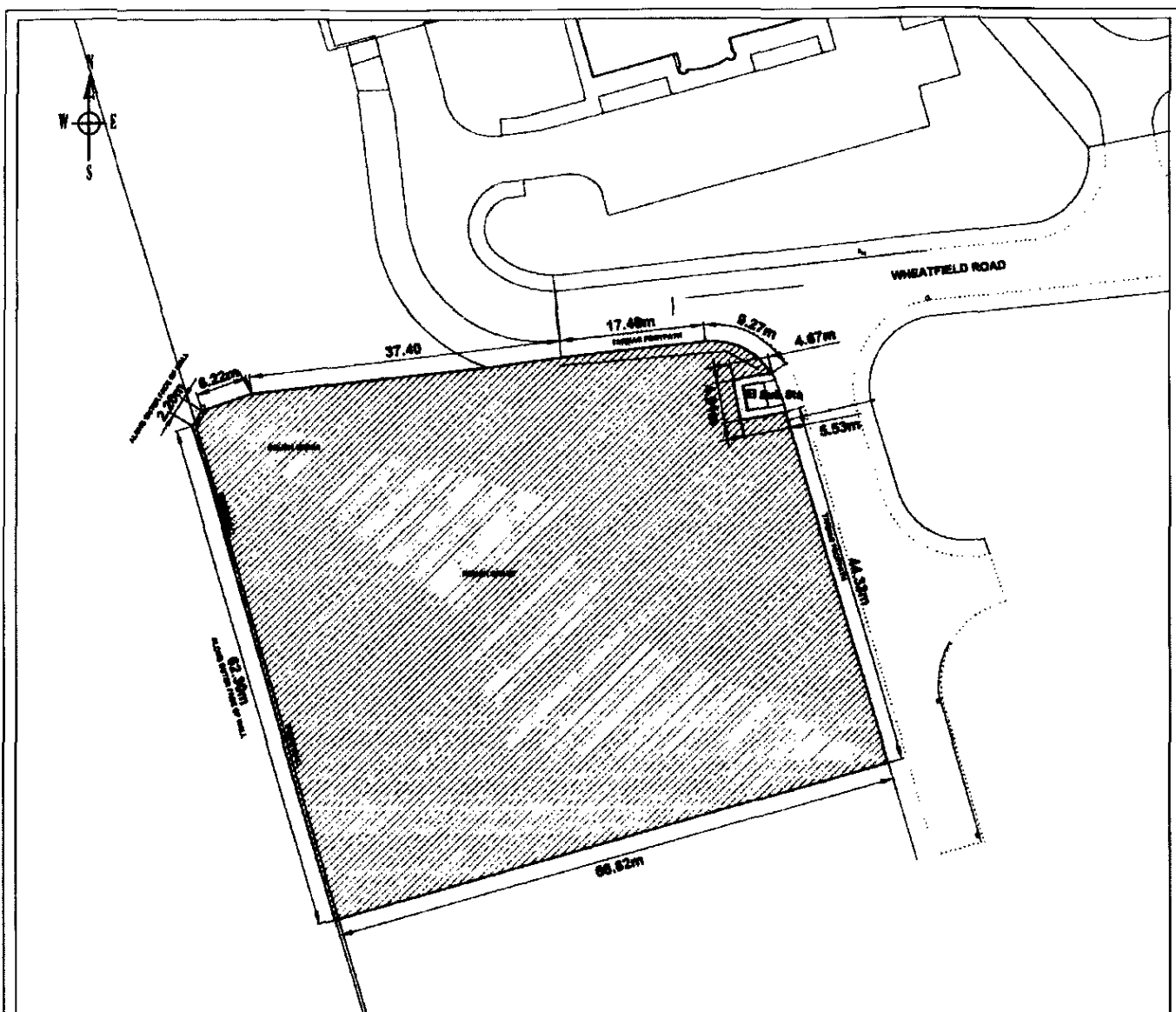

Kirkcaldy

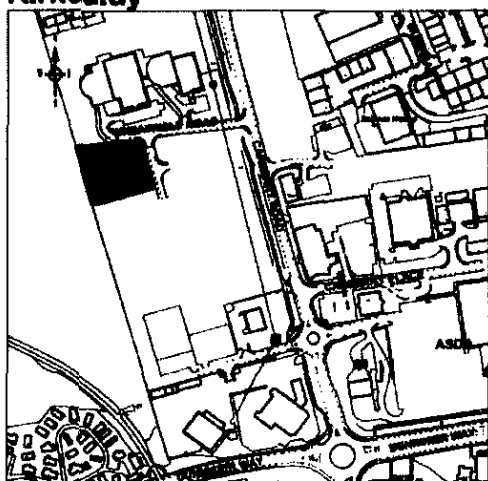

Location Plan Scale 1 : 5,000

Area hatched red extends to 0.405 hectare (1.00 acre) or thereby.
This is the Plan referred to in the foregoing
Standard Security by Caledonia Fire and
Security Property Company Limited in favour
of The Fife Council.

R Hutchison

John E. Masters

Name Chris Moodle

Scale 1 : 500 @ A3

Development Site

Wheatfield Road

Kirkcaldy

Dwg No C16KK008a

Date 07/01/2016

Department

Property Services - Estates



This map is based upon Ordnance Survey material with the permission of Ordnance Survey on behalf of the Controller of Her Majesty's Stationery Office (C) Crown copyright. Unauthorised reproduction infringes Crown copyright and may lead to prosecution or civil proceedings. Fife Council 102527368 (01/16)

STANDARD SECURITY

by

CALEDONIA FIRE AND
SECURITY PROPERTY
COMPANY LIMITED

in favour of

THE FIFE COUNCIL

2017

Subjects 0.405 hectares at
Wheatfield
Road, Kirkcaldy

Head of Legal Services
Fife Council
DX 561502,
GLENROTHES (FC).

FAS No. 2246
File Ref: BEMPS/0000329/SR