

MR05

Statement that part or the whole of the property charged
(a) has been released from the charge (b) no longer
forms part of the company's property or undertaking



You can use the WebFiling service to file this form online
Please go to www.companieshouse.gov.uk

☒ **What this form is for**
You may use this form to register
a statement that part or the
whole of the property charged
has either (a) been released from
the charge or (b) no longer forms
part of the company's property

☐ **What this form is NO**
You may not use this to
register this statement!
LLP Use form LL MR1

SATURDAY



A04

A3YB524J

03/01/2015

#41

COMPANIES HOUSE

1 Company details

Company number 0 8 1 5 9 3 0 8

Company name in full FOREST HOLIDAYS LIMITED

→ **Filling in this form**
Please complete in typescript or in
bold black capitals

All fields are mandatory unless
specified or indicated by *

2 Charge creation

When was the charge created?

→ **Before 06/04/2013** Complete **Part A and Part C**

→ **On or after 06/04/2013** Complete **Part B and Part C**

Part A Charges created before 06/04/2013

A1 Charge creation date

Please give the date of creation of the charge

Charge creation date 2 8 0 2 2 0 1 3

A2 Charge number

Please give the charge number This can be found on the certificate

Charge number* 6

A3 Description of instrument (if any)

Please give a description of the instrument (if any) by which the charge is
created or evidenced

Instrument description LEGAL CHARGE

Continuation page
Please use a continuation page if
you need to enter more details

MR05

Statement that part or the whole of the property charged (a) has been released from the charge (b) no longer forms part of the company's property or undertaking

A4

Short particulars of the property or undertaking charged

	Please give the short particulars of the property or undertaking charged	
Short particulars	<p>BY WAY OF FIRST LEGAL MORTGAGE THE PROPERTY BEING</p> <p>(1) Spiers Campsite, Cropton, Pickering, North Yorkshire (T/NO NYK400575), (2) Woodlands Campsite, Bracelands Drive, Christchurch, Coleford (T/NOs GR367794 and GR352652), (3) Christchurch Campsite, Bracelands Drive, Christchurch, Coleford (T/NO GR367692), (4) Black Wood, Stratton Park Estate, Micheldever, Winchester registered (T/NO HP754642), (5) Thorpe Park Camping Site, West Harling, Norfolk (T/NO NK342773), (6) Beddgelert Caravan and Camping Site, Beddgelert Forest, Caernarfon (T/NO CYM302681), (7) Deerpark Forest Cabin Site, Liskeard, Cornwall (T/NOs CL227906 and CL227910), (8) Keldy Cabin Site, Cropton, Nr Pickering, North Yorkshire (T/NO NYK322599), (9) Sherwood Forest Cabin Site and Land at Sherwood Pines, Edwinstone, Nottingham (T/NOs NT480010 and NT473965)</p> <p>PLUS</p> <p>All plant and machinery, Insurance Policies, Goodwill and Licences</p>	<p>Continuation page</p> <p>Please use a continuation page if you need to enter more details</p>

Part B

Charges created on or after 06/04/2013

B1

Charge code

	Please give the charge code This can be found on the certificate																
Charge code ①	<table border="1"><tr><td></td><td></td><td></td><td></td><td>-</td><td></td><td></td><td></td><td></td><td></td><td>-</td><td></td><td></td><td></td><td></td></tr></table>					-						-					<p>① Charge code</p> <p>This is the unique reference code allocated by the registrar</p>
				-						-							

MR05

Statement that part or the whole of the property charged (a) has been released from the charge (b) no longer forms part of the company's property or undertaking

Part C To be completed for all charges

C1

Cease or release

Please tell us about the property or undertaking

Part of the property or undertaking charged

- ☐ has been released from the charge
- ☐ no longer forms part of the company's property or undertaking
- ☒ has been released from the charge and no longer forms part of the company's property or undertaking

→ Go to **Section C2**

or

All of the property or undertaking charged

- ☐ has been released from the charge
- ☐ no longer forms part of the company's property or undertaking
- ☐ has been released from the charge and no longer forms part of the company's property or undertaking

→ Go to **Section C3**

C2

Description of assets or property ①

Please give a brief description of assets or property released from the charge and/or a brief description of any property which has ceased to form part of the company's property or undertaking

Description of assets
or property

THAT PART OF THE LEASEHOLD PROPERTY KNOWN AS CHRISTCHURCH CAMPSITE, BRACELANDS DRIVE, CHRISTCHURCH, COLEFORD (T/NO GR367692) EDGED RED AND EDGED ORANGE (LESS THE AREA SHOWN HATCHED BLUE THAT SITS WITHIN THE RED EDGING) ON THE ATTACHED PLAN

① This section must be completed where part of the property or undertaking has been released from the charge or no longer forms part of the company's property or undertaking

Continuation page

Please use a continuation page if you need to enter more details

MR05

Statement that part or the whole of the property charged (a) has been released from the charge (b) no longer forms part of the company's property or undertaking

C3

Details of the person delivering this statement and their interest in the charge

	Please give the name of the person delivering this statement		
Name	RICHARD PALMER		
	Please give the address of the person delivering this statement		
Building name/number	BATH YARD		
Street	BATH LANE		
	MOIRA		
Post town	SWADLINCOTE		
County/Region			
Postcode	D E 1 2 6 B A		
	Please give the person's interest in the charge (e g chargor/chargee etc)		
Person's interest in the charge	DIRECTOR OF CHARGOR		

C4

Signature

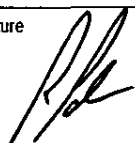
	Please sign the form here		
Signature	Signature X  X		

MR05

Statement that part or the whole of the property charged (a) has been released from the charge (b) no longer forms part of the company's property or undertaking



Presenter information

You do not have to give any contact information, but if you do, it will help Companies House if there is a query on the form. The contact information you give will be visible to searchers of the public record.

Contact name Vijan Ghedia 2099954/NKP2/VJG2

Company name Wragge Lawrence Graham & Co LLP

Address Two Snowhill

Post town Birmingham

County/Region West Midlands

Postcode B 4 6 W R

Country United Kingdom

DX DX 312501 Birmingham 86

Telephone 08709031000



Checklist

We may return forms completed incorrectly or with information missing.

Please make sure you have remembered the following

- ☐ The company name and number match the information held on the public Register

Part A Charges created before 06/04/2013

- ☐ You have given the charge date
☐ You have given the charge number (if appropriate)
☐ You have completed the Description of instrument and Short particulars in Sections A3 and A4

Part B Charges created on or after 06/04/2013

- ☐ You have given the charge code

Part C To be completed for all charges

- ☐ You have ticked the appropriate boxes in Section C1
☐ You have given a description of assets or property released from the charge (if appropriate)
☐ You have given the details of the person delivering this statement in Section C3
☐ You have signed the form



Important information

Please note that all information on this form will appear on the public record.



Where to send

You may return this form to any Companies House address. However, for expediency, we advise you to return it to the appropriate address below.

For companies registered in England and Wales.
The Registrar of Companies, Companies House,
Crown Way, Cardiff, Wales, CF14 3UZ
DX 33050 Cardiff

For companies registered in Scotland
The Registrar of Companies, Companies House,
Fourth floor, Edinburgh Quay 2,
139 Fountainbridge, Edinburgh, Scotland, EH3 9FF
DX ED235 Edinburgh 1
or LP - 4 Edinburgh 2 (Legal Post)

For companies registered in Northern Ireland*
The Registrar of Companies, Companies House,
Second Floor, The Linenhall, 32-38 Linenhall Street,
Belfast, Northern Ireland, BT2 8BG
DX 481 N R Belfast 1



Further information

For further information, please see the guidance notes on the website at www.companieshouse.gov.uk or email enquiries@companieshouse.gov.uk

This form is available in an alternative format. Please visit the forms page on the website at www.companieshouse.gov.uk

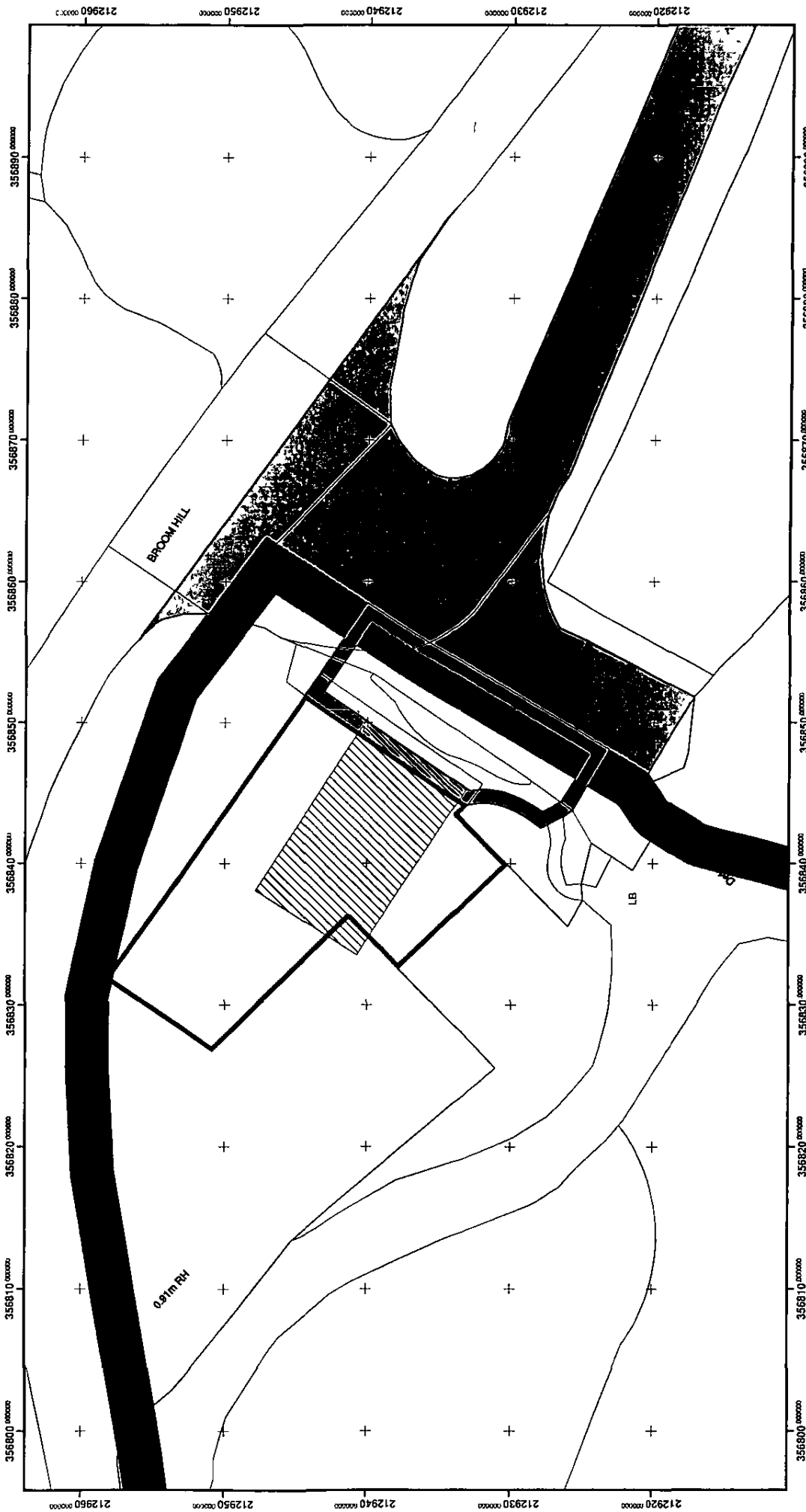

Compilation drawing of reception building

- ☒ Building area shown in current lease
- ☐ Footprint of existing building
- ☐ Area of access to existing building

WEST ENGLAND FOREST DISTRICT SUBJECT Reception Building_Forest Holidays		Nat Grid Ref SO5684 1293 1 50,000 162 County Gloucestershire File No AD/18/4	Forestry Commission England
Scale 1 200@A3 Map Nos SO5612 1 2500 edn 2013	FORESTRY COMMISSION Reproduced from the Ordnance Survey Map with the Permission of the Controller of Her Majesty's Stationery Office. Unauthorised reproduction infringes Crown copyright and may lead to prosecution or civil proceedings. Crown copyright reserved. OS Licence number 100025498		
Prepared by D H Date 22/05/14 Any linear measurements shown are in METERS			