



Registration of a Charge

Company name: **NEWHOUSE MILL LIMITED**

Company number: **05500567**



X7FGWK3F

Received for Electronic Filing: **28/09/2018**

Details of Charge

Date of creation: **27/09/2018**

Charge code: **0550 0567 0002**

Persons entitled: **STEPHEN JOHN BIGLIN**

Brief description: **LAND AT MILL FARM, HALSHAM REGISTERED UNDER PART OF TITLE
NUMBER HS241385**

Authentication of Form

This form was authorised by: **a person with an interest in the registration of the charge.**

Authentication of Instrument

Certification statement: **I CERTIFY THAT THE ELECTRONIC COPY INSTRUMENT
DELIVERED AS PART OF THIS APPLICATION FOR REGISTRATION
IS A CORRECT COPY OF THE ORIGINAL INSTRUMENT.**

Certified by: **PARNALLS SOLICITORS LIMITED**



CERTIFICATE OF THE REGISTRATION OF A CHARGE

Company number: 5500567

Charge code: 0550 0567 0002

The Registrar of Companies for England and Wales hereby certifies that a charge dated 27th September 2018 and created by NEWHOUSE MILL LIMITED was delivered pursuant to Chapter A1 Part 25 of the Companies Act 2006 on 28th September 2018 .

Given at Companies House, Cardiff on 2nd October 2018

The above information was communicated by electronic means and authenticated by the Registrar of Companies under section 1115 of the Companies Act 2006



Companies House



THE OFFICIAL SEAL OF THE
REGISTRAR OF COMPANIES

HM Land Registry

Legal charge of a registered estate

CH1

This form should be accompanied by either Form AP1 or Form FR1

Any parts of the form that are not typed should be completed in black ink and in block capitals.

If you need more room than is provided for in a panel, and your software allows, you can expand any panel in the form. Alternatively use continuation sheet CS and attach it to this form.

Conveyancer is a term used in this form. It is defined in rule 217A, Land Registration Rules 2003 and includes persons authorised under the Legal Services Act 2007 to provide reserved legal services relating to land registration and includes solicitors and licensed conveyancers.

For information on how HM Land Registry processes your personal information, see our [Personal Information Charter](#).

Leave blank if not yet registered.

Insert address including postcode (if any) or other description of the property, for example 'land adjoining 2 Acacia Avenue'.

Give full name(s).

Complete as appropriate where the borrower is a company.

1	Title number(s) of the property: HS241385
2	Property: Land at Mill Farm, Halsham as shown edged red on the attached plan which forms part of the property comprised within title HS241385
3	Date: 27 September 2018
4	Borrower: Newhouse Mill Limited <u>For UK incorporated companies/LLPs</u> Registered number of company or limited liability partnership including any prefix: 05500567 <u>For overseas companies</u> (a) Territory of incorporation: (b) Registered number in the United Kingdom including any prefix:

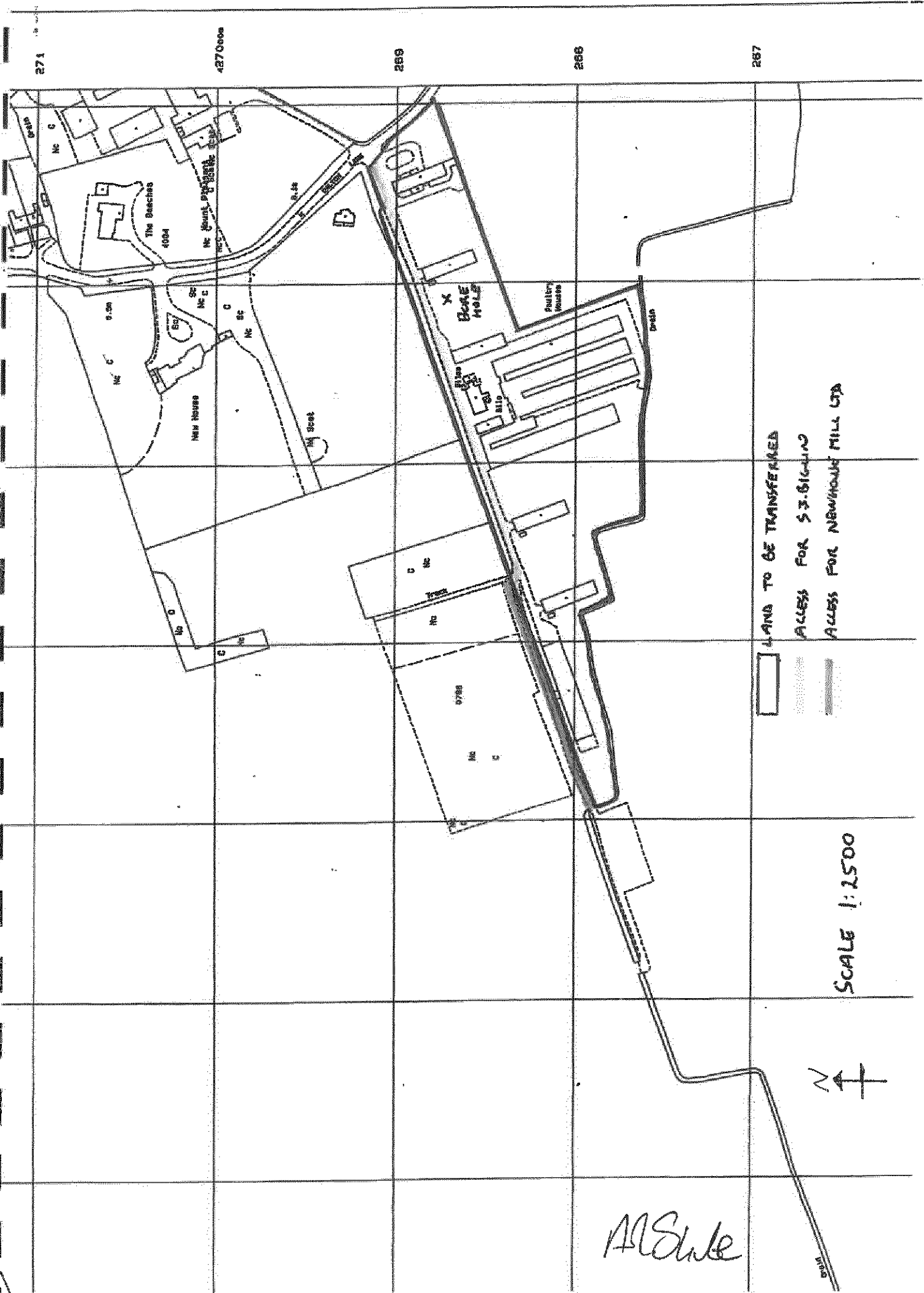

- LAND TO BE TRANSFERRED
- ACCESS FOR S3-BIGLAND
- ACCESS FOR NEWHOLD MILL LTD

SCALE 1:2500

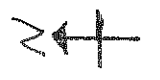

A. S. White

Give full name(s).

Complete as appropriate where the lender is a company. Also, for an overseas company, unless an arrangement with HM Land Registry exists, lodge either a certificate in Form 7 in Schedule 3 to the Land Registration Rules 2003 or a certified copy of the constitution in English or Welsh, or other evidence permitted by rule 183 of the Land Registration Rules 2003.

Each proprietor may give up to three addresses for service, one of which must be a postal address whether or not in the UK (including the postcode, if any). The others can be any combination of a postal address, a UK DX box number or an electronic address.

Place 'X' in any box that applies.

Add any modifications.

Place 'X' in the appropriate box(es).

You must set out the wording of the restriction in full.

Standard forms of restriction are set out in Schedule 4 to the Land Registration Rules 2003.

Insert details of the sums to be paid (amount and dates) and so on.

5 Lender for entry in the register:

Stephen John Biglin

For UK incorporated companies/LLPs

Registered number of company or limited liability partnership including any prefix:

For overseas companies

(a) Territory of incorporation:

(b) Registered number in the United Kingdom including any prefix:

6 Lender's intended address(es) for service for entry in the register:

Elm Tree Farm, Southside Road, Halsham, East Yorkshire, HU12 0BP

7 The borrower with

☒ full title guarantee

☐ limited title guarantee

charges the property by way of legal mortgage as security for the payment of the sums detailed in panel 9

8 ☐ The lender is under an obligation to make further advances and applies for the obligation to be entered in the register

☒ The borrower applies to enter the following standard form of restriction in the proprietorship register of the registered estate:

No disposition of the registered estate by the proprietor of the registered estate is to be registered without a written consent signed by the proprietor for the time being of the charge dated 27 September 2018 in favour of Stephen John Biglin referred to in the charges register.

9 Additional provisions

9.1 The Borrower has agreed to repay the sum of £182,500 to the Lender on or before 27 September 2020 as provided for by a Contract for Sale dated the date hereof and made between (1) the Lender and (2) the Borrower.

9.2 On repayment of this Legal Charge, the Lender will provide a duly executed Form DS1 within 14 days of written request from the Borrower, following repayment of the sum provided in Clause 9.1 above.

9.3 This deed may be executed in any number of counterparts, each of which when executed and delivered shall constitute a duplicate original, but all the counterparts shall together constitute one deed.

The borrower must execute this charge as a deed using the space opposite. If there is more than one borrower, all must execute. Forms of execution are given in Schedule 9 to the Land Registration Rules 2003. If a note of an obligation to make further advances has been applied for in panel 8 this document must be signed by the lender or its conveyancer.

10 Execution

SIGNED as a deed by the said
Stephen John Biglin
in the presence of the person
named below and delivered at
the date hereof:-

Witness signature

Witness name

Address

EXECUTED as a deed by
Newhouse Mill Limited
acting by a director ~~and its~~ *In the presence*
~~company secretary or two~~ *of A WITNESS*
~~directors~~ and delivered at
the date hereof:-

Director

Director/Secretary
WITNESS

AL Gutter

B P

Ben Mitchell
15-19 Westgate Street,
Lancaster, Lancashire
PL1 1AB
Solicitor

WARNING

If you dishonestly enter information or make a statement that you know is, or might be, untrue or misleading, and intend by doing so to make a gain for yourself or another person, or to cause loss or the risk of loss to another person, you may commit the offence of fraud under section 1 of the Fraud Act 2006, the maximum penalty for which is 10 years' imprisonment or an unlimited fine, or both.

Failure to complete this form with proper care may result in a loss of protection under the Land Registration Act 2002 if, as a result, a mistake is made in the register.

Under section 66 of the Land Registration Act 2002 most documents (including this form) kept by the registrar relating to an application to the registrar or referred to in the register are open to public inspection and copying. If you believe a document contains prejudicial information, you may apply for that part of the document to be made exempt using Form EX1, under rule 136 of the Land Registration Rules 2003.