

# M

CHFP041

COMPANIES FORM No. 395

014606/10

## Particulars of a mortgage or charge

Pursuant to section 395 of the Companies Act 1985

# 395

**A fee of £10 is payable to Companies House in respect of each register entry for a mortgage or charge.**

FEE  PAID  
£ 10

Please do not  
write in  
this margin

Please complete  
legibly, preferably  
in black type or  
bold block  
lettering

To the Registrar of Companies  
(Address overleaf - Note 6)

For official use

Company number

COMPANIES HOUSE

04131015

Name of company

003

\* Insert full name  
of company

\* P &amp; E PROPERTIES LIMITED

Date of creation of the charge

8TH JANUARY 2004

Description of the instrument (if any) creating or evidencing the charge (note 2)

LEGAL CHARGE

Amount secured by the mortgage or charge

All moneys and liabilities matured or unmatured whether actual or contingent which are or may at any time hereafter be or become from time to time due owing or incurred to the Bank by the Company or in respect of which the Company may be or become liable to the Bank on any current loan or other account or otherwise in any manner whatsoever (including the amount of any note or bill made, accepted, endorsed, discounted or paid and of any liability under any guarantee or indemnity or other instrument whatsoever given or assumed by the Bank for or at the request of the Company) in all cases whether alone or jointly with any other person in and in whatever style name or form and whether as principal or surety and all commission, discount and other banking charges including legal costs (on a full indemnity basis) and disbursements and any expenses incurred by the Bank in relation to this Legal Charge or any other security held by the Bank for the same indebtedness or in enforcing the same together with interest compounded quarterly to the date of repayment

Names and addresses of the mortgagees or persons entitled to the charge

~~P & E PROPERTIES LIMITED c/o 105 Seven Sisters Road, London~~

BANK OF CYPRUS (LONDON) LIMITED

87/93 CHASE SIDE, LONDON.

Postcode N7 7QP

FAX PER FAX  
27-01-04

Presenter's name, address and  
reference (if any):

JST Mackintosh  
Colonial Chambers  
Temple Street L2 5RH  
DX 14278 Liverpool 1

For official use

Mortgage

PMO  
COMPANIES HOUSE

\*PG730003\*

A07

COMPANIES HOUSE

\*AH526005\*

0928

21/1/04

0647

24/01/04

FAX  
DATE

Time critical reference

Com 395-1/2

Short particulars of all the property mortgaged or charged

all that freehold and leasehold property know as 51 Derby Road, Widnes, Cheshire WA8 9LQ together with all buildings and fixtures (including trade and tenants's fixtures)

Please do not write in this margin

Please complete legibly, preferably in black type or bold block lettering

X

A fee of £10 is payable to Companies House in respect of each register entry for a mortgage or charge. (See Note 5)

Particulars as to commission allowance or discount (note 3)

Signed JST MACKINTOSH

Date 22 JANUARY 2004

On behalf of [company] [mortgagee/chargee]\*

\*Delete as appropriate

Notes.

1. The original instrument (if any) creating or evidencing the charge, together with these prescribed particulars correctly completed must be delivered to the Registrar of Companies within 21 days after the date of creation of the charge (section 395). If the property is situated and the charge was created outside the United Kingdom delivery to the Registrar must be effected within 21 days after the date on which the instrument could in due course of post, and if dispatched with due diligence, have been received in the United Kingdom (section 398). A copy of the instrument creating the charge will be accepted where the property charged is situated and the charge was created outside the United Kingdom (section 398) and in such cases the copy must be verified to be a correct copy either by the company or by the person who has delivered or sent the copy to the registrar. The verification must be signed by or on behalf of the person giving the verification and where this is given by a body corporate it must be signed by an officer of that body. A verified copy will also be accepted where section 398(4) applies (property situate in Scotland or Northern Ireland) and Form No. 398 is submitted.
2. A description of the instrument, eg "Trust Deed", "Debenture", "Mortgage" or "Legal charge", etc, as the case may be, should be given.
3. In this section there should be inserted the amount or rate per cent. of the commission, allowance or discount (if any) paid or made either directly or indirectly by the company to any person in consideration of his;
  - (a) subscribing or agreeing to subscribe, whether absolutely or conditionally, or
  - (b) procuring or agreeing to procure subscriptions, whether absolute or conditional, for any of the debentures included in this return. The rate of interest payable under the terms of the debentures should not be entered.
4. If any of the spaces in this form provide insufficient space the particulars must be entered on the prescribed continuation sheet.
5. Cheques and Postal Orders are to be made payable to **Companies House**.
6. The address of the Registrar of Companies is:-  
Companies House, Crown Way, Cardiff CF4 3UZ.

Please do not  
write in this  
margin

## Particulars of a mortgage or charge (continued)

Continuation sheet No 1  
to Forms Nos 395 and 410 (Scot)

Company number

04131015

Please complete  
legibly, preferably  
in black type, or  
bold block lettering

Name of company

P & E PROPERTIES LIMITED

Limited\*

\*Delete if  
inappropriate

Description of the instrument creating or evidencing the mortgage or charge (continued) (note 2)

at such rate as may be agreed from time to time between the Company and the Bank or according to the usual practice of the Bank as well after as before any demand made or judgement obtained hereunder.

Amount due or owing on the mortgage or charge (continued)

Please do not  
write in this  
margin

Please complete  
legibly, preferably  
in black type, or  
bold block  
lettering.

# Fax

**JST**  
**Mackintosh**  
Commercial & Insurance Lawyers  
**Liverpool**  
Colonial Chambers  
Temple Street L2 5RH  
Tel: 0151 282 2828  
Fax: 0151 282 2848  
E-mail: [info@jstmackintosh.co.uk](mailto:info@jstmackintosh.co.uk)  
[www.jstmackintosh.co.uk](http://www.jstmackintosh.co.uk)  
DX number: 14278 LIVERPOOL 1

To: Companies House - "Mortgage Section"  
From: John L Shield

FAO: LEANNE Fax: 029 2038 0827

Our Ref: JLS/SO/PAV0006/0003 Your Ref: 04131015

Pages: 3 Date: 27 January 2004

Documents accompanying this fax transmission contain confidential information belonging to the sender which is legally privileged. The information is intended only for the use of the individual or entity above. If you are not the intended recipient, you are hereby notified that any disclosure, copying, distribution or taking of any action in reliance on the contents of this faxed information is strictly prohibited. If you have received this fax in error, please notify us immediately by telephone. Thank you.

**Please contact us immediately if there are any problems with this transmission.**

☒ Urgent

For Review

Please Comment

Please Reply

**Re: P & E PROPERTIES LIMITED - 04131015 - P/O 51 DERBY ROAD, WIDNES, CHESHIRE WA8 9LQ**

Further to our telephone conversation, I enclose amended Form 395 and apologise for the error. I look forward to receiving registered documentation from you.

Yours sincerely

*S.B.O'Brien*

Sheila O'Brien - PA to John Shield  
**JST Mackintosh**

Direct Line: 0151 282 2830  
Email: [sobrien@jstmackintosh.co.uk](mailto:sobrien@jstmackintosh.co.uk)  
Mailbox: 258

**M**

CHFP041

**COMPANIES FORM No. 395****Particulars of a mortgage or charge**

Pursuant to section 395 of the Companies Act 1985

**395****A fee of £10 is payable to Companies House in respect of each register entry for a mortgage or charge.**Please do not  
write in  
this marginPlease complete  
legibly, preferably  
in black type or  
bold block  
lettering\* Insert full name  
of companyTo the Registrar of Companies  
(Address overleaf - Note 6)

For official use

Company number

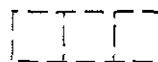

04131015

Name of company

\* P &amp; E PROPERTIES LIMITED

Date of creation of the charge

8TH JANUARY 2004

Description of the instrument (if any) creating or evidencing the charge (note 2)

LEGAL CHARGE

Amount secured by the mortgage or charge

All moneys and liabilities matured or unmatured whether actual or contingent which are or may at any time hereafter be or become from time to time due owing or incurred to the Bank by the Company or in respect of which the Company may be or become liable to the Bank on any current loan or other account or otherwise in any manner whatsoever (including the amount of any note or bill made, accepted, endorsed, discounted or paid and of any liability under any guarantee or indemnity or other instrument whatsoever given or assumed by the Bank for or at the request of the Company) in all cases whether alone or jointly with any other person in and in whatever style name or form and whether as principal or surety and all commission, discount and other banking charges including legal costs (on a full indemnity basis) and disbursements and any expenses incurred by the Bank in relation to this Legal Charge or any other security held by the Bank for the same indebtedness or in enforcing the same together with interest compounded quarterly to the date of repayment

Names and addresses of the mortgagees or persons entitled to the charge

BANK OF CYPRUS (LONDON) LIMITED 87/93 CHASE SIDE LONDON

Postcode N14 5BU

Presentor's name, address and  
reference (if any):

JST Macintosh  
Colonial Chambers  
Temple Street L2 5RH  
DX 14278 Liverpool 1

For official use

Mortgage section

Post room

Time critical reference

## Short particulars of all the property mortgaged or charged

all that freehold and leasehold property know as 51 Derby Road, Widnes, Cheshire WA8 9LQ together with all buildings and fixtures (including trade and tenants's fixtures)

Please do not write in this margin

Please complete legibly, preferably in black type or bold block lettering

A fee of £10 is payable to Companies House in respect of each register entry for a mortgage or charge. (See Note 5)

Particulars as to commission allowance or discount (note 3)

Signed JST MACKINTOSH

Date 22 JANUARY 2004

On behalf of [company] [mortgagee/chargee]\*

\*Delete as appropriate

## Notes.

1. The original instrument (if any) creating or evidencing the charge, together with these prescribed particulars correctly completed must be delivered to the Registrar of Companies within 21 days after the date of creation of the charge (section 395). If the property is situated and the charge was created outside the United Kingdom delivery to the Registrar must be effected within 21 days after the date on which the instrument could in due course of post, and if dispatched with due diligence, have been received in the United Kingdom (section 398). A copy of the instrument creating the charge will be accepted where the property charged is situated and the charge was created outside the United Kingdom (section 398) and in such cases the copy must be verified to be a correct copy either by the company or by the person who has delivered or sent the copy to the registrar. The verification must be signed by or on behalf of the person giving the verification and where this is given by a body corporate it must be signed by an officer of that body. A verified copy will also be accepted where section 398(4) applies (property situate in Scotland or Northern Ireland) and Form No. 398 is submitted.
2. A description of the instrument, eg "Trust Deed", "Debenture", "Mortgage" or "Legal charge", etc, as the case may be, should be given.
3. In this section there should be inserted the amount or rate per cent. of the commission, allowance or discount (if any) paid or made either directly or indirectly by the company to any person in consideration of his:
  - (a) subscribing or agreeing to subscribe, whether absolutely or conditionally, or
  - (b) procuring or agreeing to procure subscriptions, whether absolute or conditional, for any of the debentures included in this return. The rate of interest payable under the terms of the debentures should not be entered.
4. If any of the spaces in this form provide insufficient space the particulars must be entered on the prescribed continuation sheet.
5. Cheques and Postal Orders are to be made payable to Companies House.
6. The address of the Registrar of Companies is:-  
Companies House, Crown Way, Cardiff CF4 3UZ.

FILE COPY



## CERTIFICATE OF THE REGISTRATION OF A MORTGAGE OR CHARGE

Pursuant to section 401(2) of the Companies Act 1985

COMPANY No. 04131015

THE REGISTRAR OF COMPANIES FOR ENGLAND AND WALES HEREBY CERTIFIES THAT A LEGAL CHARGE DATED THE 8th JANUARY 2004 AND CREATED BY P & E PROPERTIES LIMITED FOR SECURING ALL MONIES DUE OR TO BECOME DUE FROM THE COMPANY TO BANK OF CYPRUS (LONDON) LIMITED ON ANY ACCOUNT WHATSOEVER WAS REGISTERED PURSUANT TO CHAPTER 1 PART XII OF THE COMPANIES ACT 1985 ON THE 21st JANUARY 2004.

GIVEN AT COMPANIES HOUSE, CARDIFF THE 28th JANUARY 2004.

*P. Angela.*



THE OFFICIAL SEAL OF THE  
REGISTRAR OF COMPANIES



*Companies House*

— for the record —