

# M

COMPANIES FORM No. 395

# 395

## Particulars of a mortgage or charge

Please do not  
write in  
this margin

Pursuant to section 395 of the Companies Act 1985

Please complete  
legibly, preferably  
in black type or  
bold block  
lettering

\*Insert full name  
of company

To the Registrar of Companies

For official use Company number

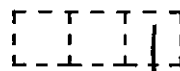

00019009

Name of company

\* THE TOXTETH REAL PROPERTY AND INVESTMENT COMPANY LIMITED

Date of creation of the charge

17th February 1996

Description of the instrument (if any) creating or evidencing the charge (note 2)

Legal Mortgage - 17th February 1996

Amount secured by the mortgage or charge

All money and liabilities whatever, whenever and howsoever incurred  
by the Company whether now or in the future.

Stamp here

Names and addresses of the mortgagees or persons entitled to the charge

Midland Bank plc, whose registered office is at Poultry, in  
the City of London

Postcode EC2P 2BX

Presentor's name, address and  
reference (if any):

Bremner Sons & Corlett  
1 Crosshall Street  
Liverpool  
L1 6DH  
JDGB

Time critical reference

For official use  
Mortgage section

NON-PART SIGN &



PMO \*P403T00D\* 217  
COMPANIES HOUSE 21/2/96  
COMPANIES HOUSE 27/02/96  
COMPANIES HOUSE 21/02/96

Short particulars of all the property mortgaged or charged

The property at 1-3 Park Street Bootle Merseyside  
with the benefit of all rights, licences, guarantees, rent deposits  
contracts, deeds, undertakings and warranties relating to the property;  
any shares or membership rights in any management company for the Property;  
any goodwill of any business from time to time carried on at the Property;  
any rental and other money payable under any lease, licence or other  
interest created in respect of the Property; and  
all other payments whatever in respect of the Property.

Please do not  
write in  
this margin

Please complete  
legibly, preferably  
in black type or  
bold block  
lettering

Particulars as to commission allowance or discount (note 3)

NIL

Signed

Date

On behalf of [company] [mortgagee/chargee]\*

\*Delete as  
appropriate

Notes

1. The original instrument (if any) creating or evidencing the charge, together with these prescribed particulars correctly completed must be delivered to the Registrar of Companies within 21 days after the date of creation of the charge (section 395). If the property is situated and the charge was created outside the United Kingdom delivery to the Registrar must be effected within 21 days after the date on which the instrument could in due course of post, and if dispatched with due diligence, have been received in the United Kingdom (section 398). A copy of the instrument creating the charge will be accepted where the property charged is situated and the charge was created outside the United Kingdom (section 398) and in such cases the copy must be verified to be a correct copy either by the company or by the person who has delivered or sent the copy to the registrar. The verification must be signed by or on behalf of the person giving the verification and where this is given by a body corporate it must be signed by an officer of that body. A verified copy will also be accepted where section 398(4) applies (property situate in Scotland or Northern Ireland) and Form No. 398 is submitted.
2. A description of the instrument, eg "Trust Deed", "Debenture", "Mortgage" or "Legal charge", etc, as the case may be, should be given.
3. In this section there should be inserted the amount or rate per cent. of the commission, allowance or discount (if any) paid or made either directly or indirectly by the company to any person in consideration of his;
  - (a) subscribing or agreeing to subscribe, whether absolutely or conditionally, or
  - (b) procuring or agreeing to procure subscriptions, whether absolute or conditional, for any of the debentures included in this return. The rate of interest payable under the terms of the debentures should not be entered.
4. If any of the spaces in this form provide insufficient space the particulars must be entered on the prescribed continuation sheet.

Page 2



FILE COPY



## CERTIFICATE OF THE REGISTRATION OF A MORTGAGE OR CHARGE

Pursuant to section 401(2) of the Companies Act 1985

COMPANY No. 00019009

THE REGISTRAR OF COMPANIES FOR ENGLAND AND WALES HEREBY CERTIFIES THAT A LEGAL MORTGAGE DATED THE 17th FEBRUARY 1996 AND CREATED BY TOXTETH REAL PROPERTY AND INVESTMENT COMPANY LIMITED (THE) FOR SECURING ALL MONIES DUE OR TO BECOME DUE FROM THE COMPANY TO MIDLAND BANK PLC ON ANY ACCOUNT WHATSOEVER WAS REGISTERED PURSUANT TO CHAPTER 1 PART XII OF THE COMPANIES ACT 1985 ON THE 21st FEBRUARY 1996.

GIVEN AT COMPANIES HOUSE, CARDIFF THE 28th FEBRUARY 1996.

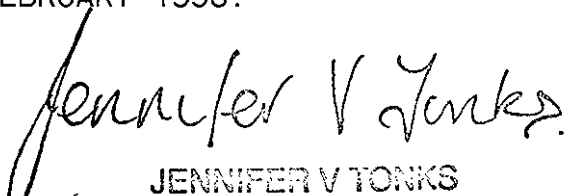
  
JENNIFER V TONKS  
for the Registrar of Companies



C O M P A N I E S H O U S E

HC026B

Post  
28/2  
En